

CITY OF MEBANE

(919) 563-9990

BUILDING PERMIT APPLICATION

Fax # (919) 563-9506

ZONING:		GPIN:		TAX MAP:		PERMIT No:	
COUNTY: Alamance / Orange		City Limits / County / ETJ		Residential / Non-residential		LOT:	
Property Address:							
Property Description:						Email:	
Owner:						Phone #: ()	
Permit Holder:						Contact Phone#: ()	
NC State Lic#:		General Contractor:				Phone #: ()	
		Address:				Total Cost: \$	
NC State Lic#:		Electrical Contractor:				Phone #: ()	
		Address:				Total Cost: \$	
NC State Lic#:		Mechanical Contractor:				Phone #: ()	
		Address:				Total Cost: \$	
NC State Lic#:		Plumbing Contractor:				Phone #: ()	
		Address:				Total Cost: \$	

LIEN AGENT NEEDED ON ALL JOBS OVER (30K) AGENTS NAME: _____

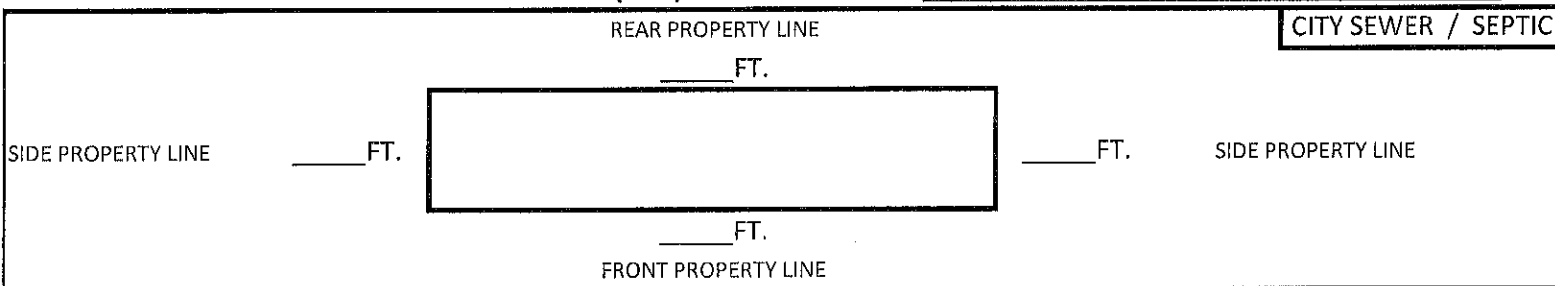

CONSTRUCTION INFORMATION - ALL boxes must be filled out

Brief Description or Class of Work		New Square Footage	Total Square Footage	Add Kitchen?	# of New Bedrooms
		Heated:	Exist:		
		Unheated:	New:		
# of New Bathrooms	Adding/ moving # of Plumbing Fixtures	Electrical Amps or # of lights switches, & outlets	Heating / A/C type	Insulate (yes or no)	Total Construction Cost
					\$
FEES:		\$	\$	\$	\$
Driveway fee: \$ 50		Water Conn. Fee \$ _____ Sewer Conn. Fee \$ _____		Water Meter Fee \$ _____	

RECEIPT #:	Plan Review Fee	HR Fee:	TOTAL FEES:
DATE:	\$	\$	\$

Will above said building or structure be located in a flood hazard area? Yes _____ No _____

Does the State of North Carolina and/or the U.S. Government require the owner to obtain a hazardous waste permit? Yes _____ No _____

Has the property that the above said building or structure is situated on been approved when required by the subdivision ordinance of Alamance County, Orange County or the applicable municipality? Yes _____ No _____

The undersigned hereby makes application as designed above, and agrees to conform to all applicable laws of Alamance County, Orange County and the State of North Carolina, and that the structure designated above is not to be occupied or used until a certificate of occupancy is issued by the City of Mebane Inspection Department. The undersigned further states that all the statements made herein are true.

Is the proposed building adjacent to any drainage way or storm drain or is the property traversed by a drainage way or storm drain having a contributing drainage area of 5 acres or more? Yes _____ No _____

If yes is marked, a Flood Study and grading plan shall be provided with the building permit application.

APPLICANT'S SIGNATURE _____ DATE _____

Print Name: _____

APPROVED BY _____ DATE _____